

City of Edinburgh Council

CCWP

3 October 2013

Primary School Estate Rising Rolls

Billy MacIntyre
Head of Resources
Children and Families

Population Trend

Population Aged 5-11 in the City of Edinburgh 1981-2012

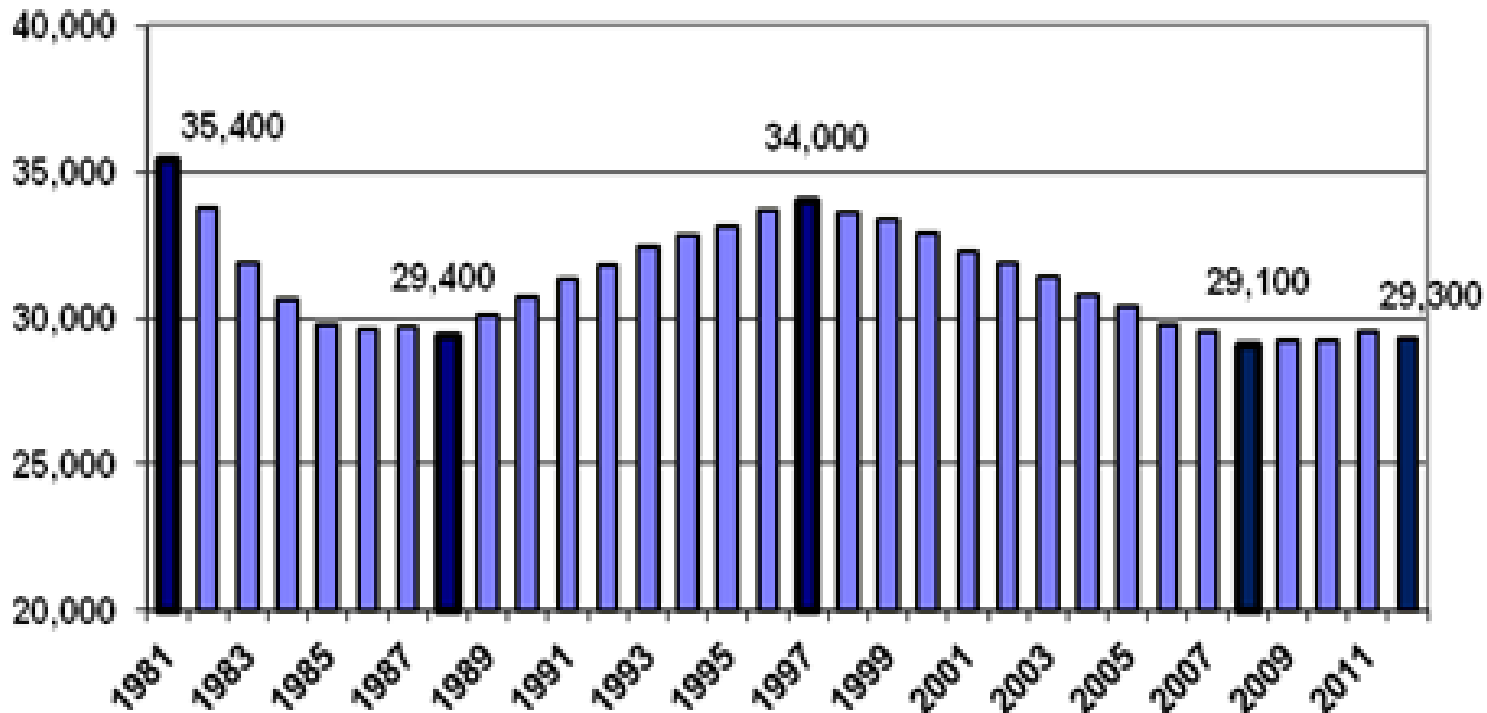

Correlation with School Rolls

Population Aged 5-11 and Primary School Rolls 1990-2012

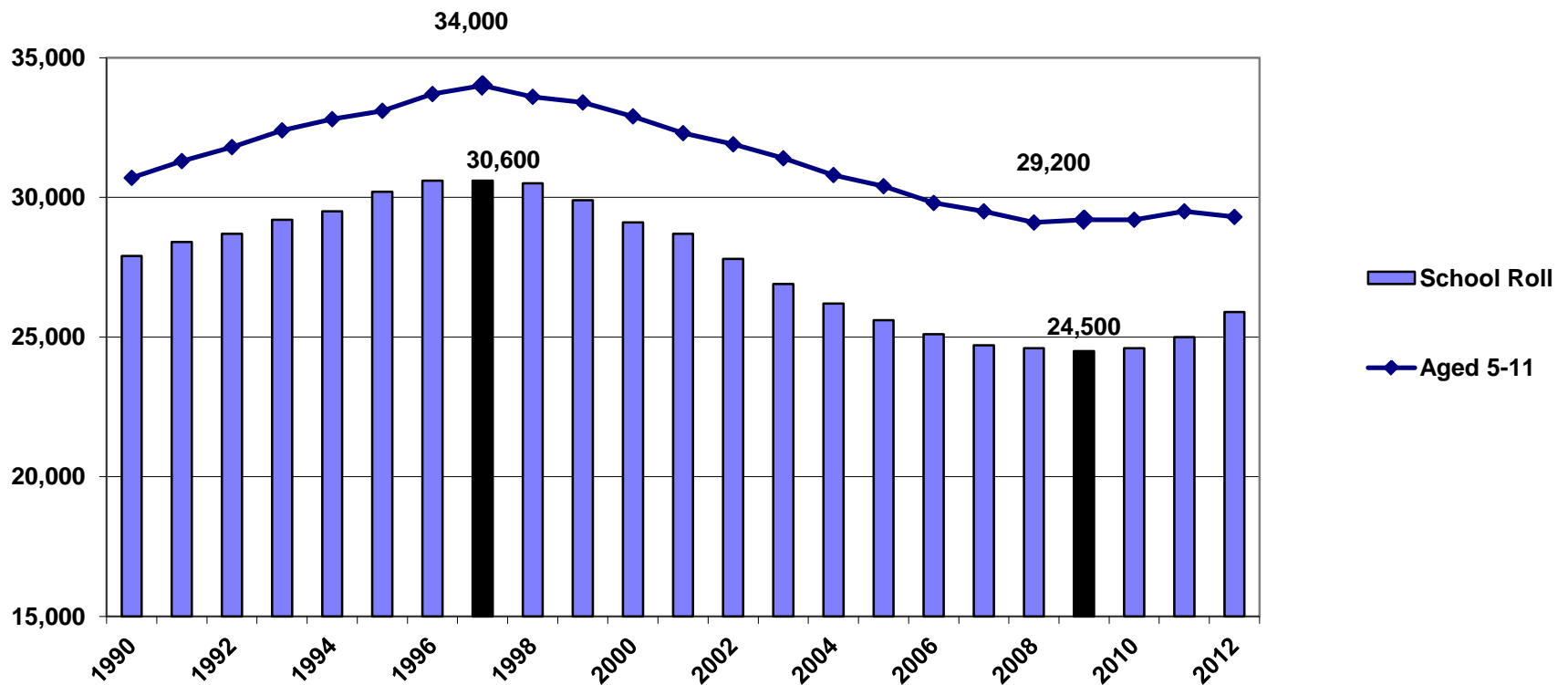

P1 Intakes and Births (5 years on)

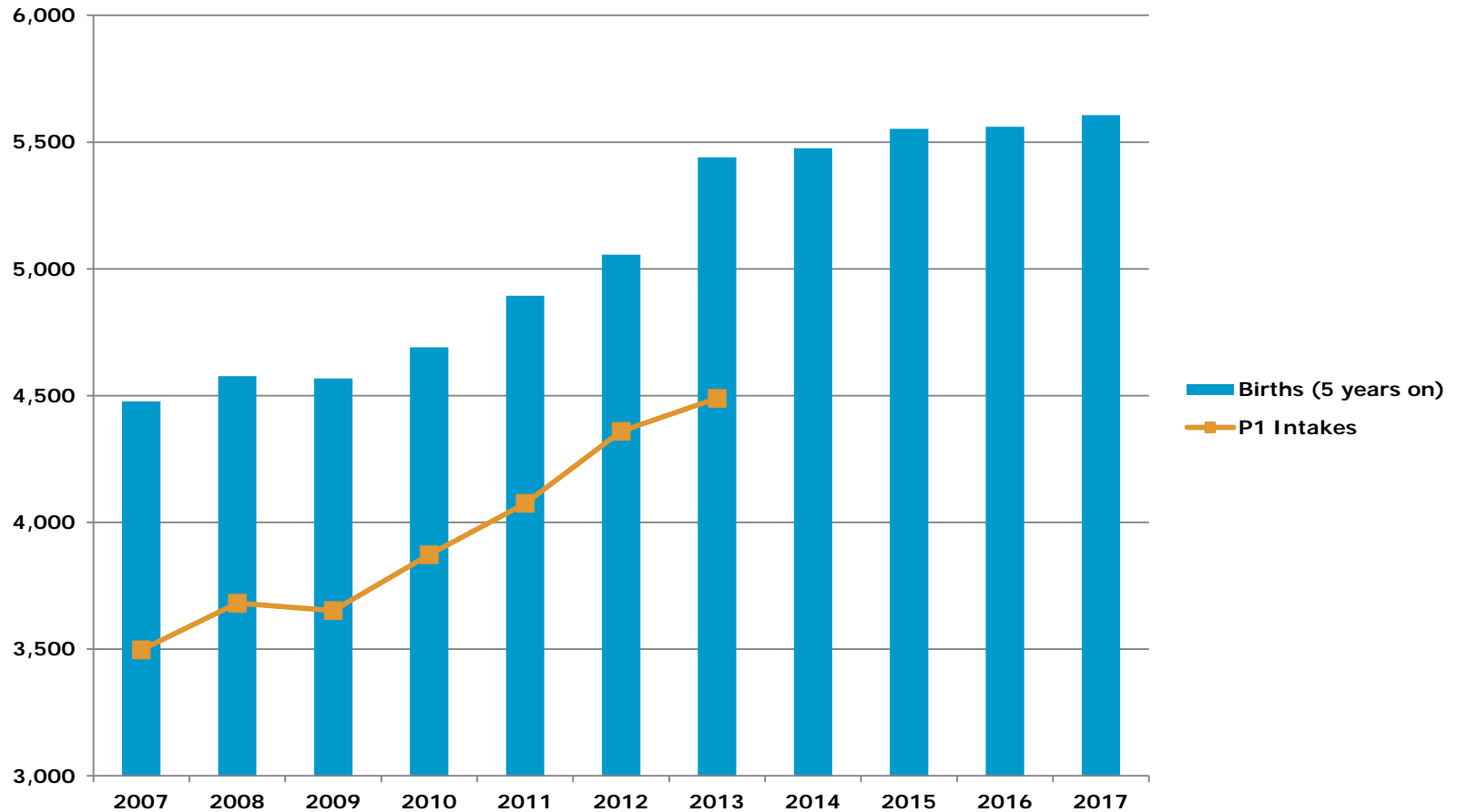

Projected P1 Intakes to 2020

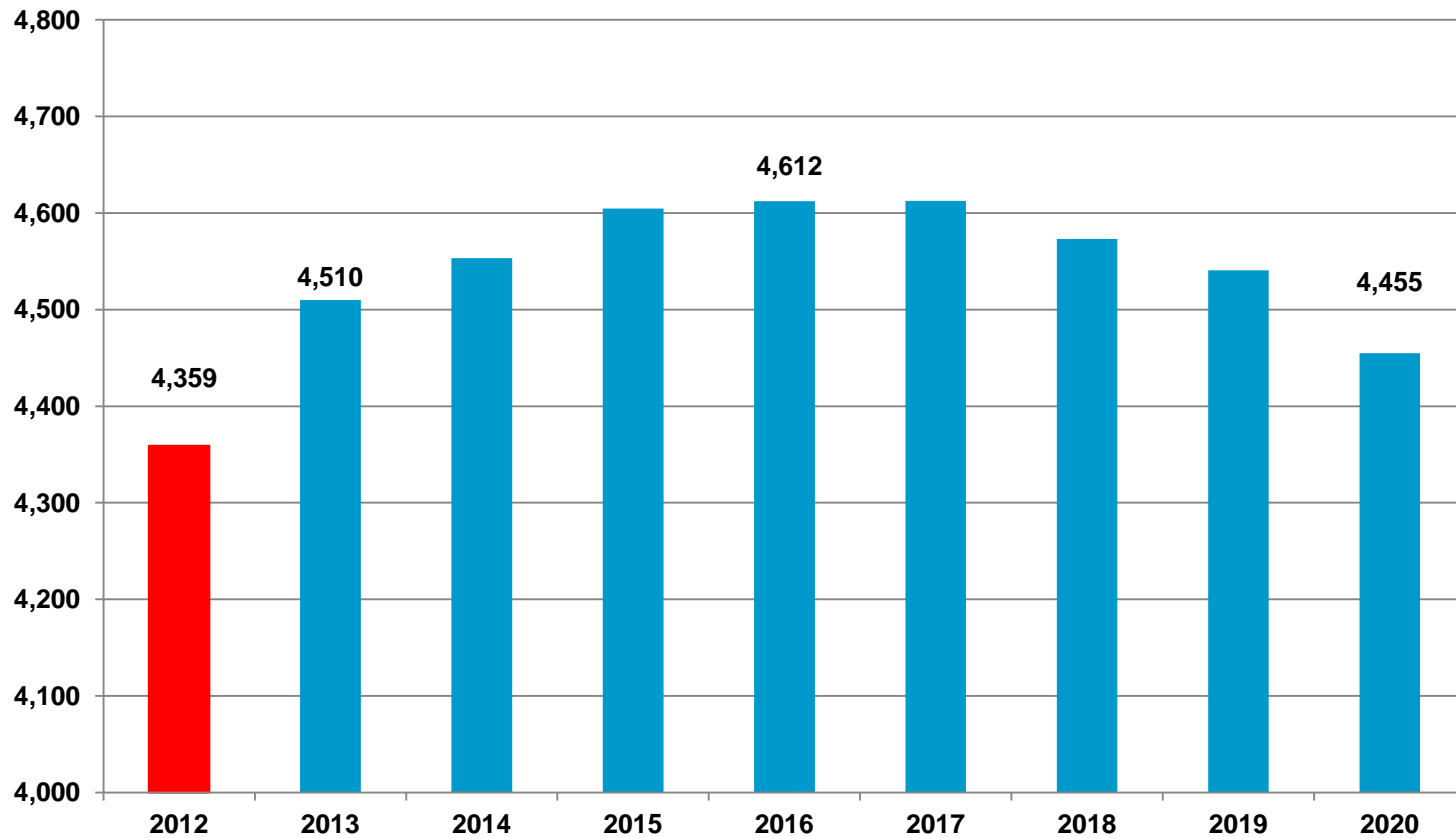

Projected Primary School Rolls

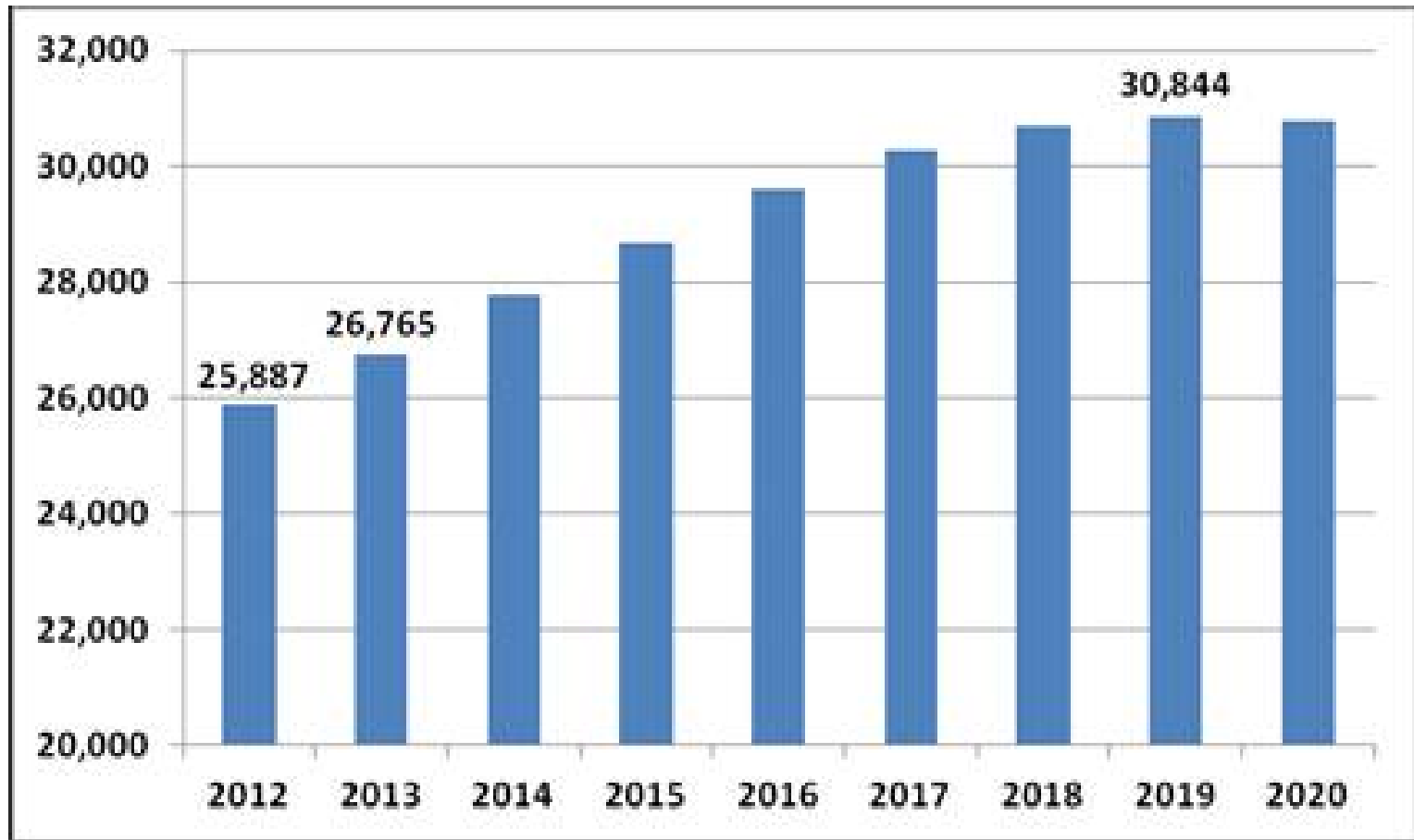

Primary Estate Spare Places

- Currently just over 5,000 spare places
- Two thirds of spare places in P4-P7
- Pressure is in lower stages
- Lose 8% of roll as pupils move from P1-P7
- Schools with spare places are not where they are needed
- In 2012, 24% of primary pupils did not attend their catchment school

Forecasting Intakes

- Catchment areas as base for projections
- Large variations at local level; peaks and troughs
- No consistent close correlation between births and P1 intakes at catchment level
- Changing trends:
 - Migration across the city
 - Housing market; less people moving
 - Private sector influence
- Parental choice

Rising Rolls - Strategy

- Update roll projections on an annual basis
- Identify schools with potential future pressure
- Assess options for addressing pressure in consultation with schools
- Where new accommodation required engage with schools to agree approach and design
- Secure planning and other consents in advance of go/no go decision in January – ensures only build when required; £15m funding available
- Deliver any new accommodation required for the start of the new school year

Phase 1 delivered August 2013

- Two class accommodation at Granton
- Three class accommodation at Wardie
- Four class accommodation at Trinity
- Refurbishment of temporary units at Blackhall and James Gillespie's
- Minor reconfiguration works at Craigour Park, Holy Cross, St Mary's and Oxfangs
- Extensions at Towerbank and Corstorphine
- New classrooms at James Gillespie's











Phase 2 - August 2014 and beyond

- Estate Working Group has considered potential accommodation pressures facing ten city primary schools in August 2014 or beyond
- Approach agreed for each school reported to Education, Children and Families on 8 October
- Plans for new build being progressed at Broughton, Craigour Park, Liberton, St David's RC and Victoria if required for August 2014 and future years
- Feasibility studies being progressed at Balgreen, Flora Stevenson's, Fox Covert and Stockbridge
- Watching brief at St Marys (Leith)

Phase 2 - August 2014 and beyond

- Continuing to use Hub South East Scotland for new build accommodation
- Secured cost savings and potential further efficiencies in design
- New design team appointed; Scott Brownrigg
- Far more extensive consultation and engagement with schools on design
- Designs will be submitted for planning in late October but presented to schools in advance
- Go/no go decision in January 2014
- No necessity for decant expected

Evolution - The Classroom

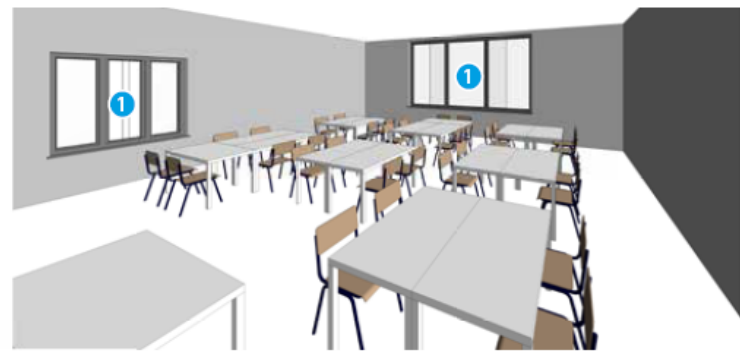
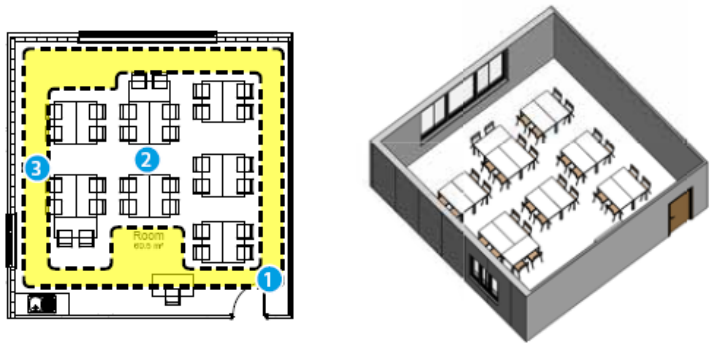

Existing Rising Rolls Phase 1 Classroom

- 1 Inner corner - daylighting and ventilation issues / small windows
- 2 Square layout gets broken up when zoned for uses
- 3 Peripheral layout is inflexible

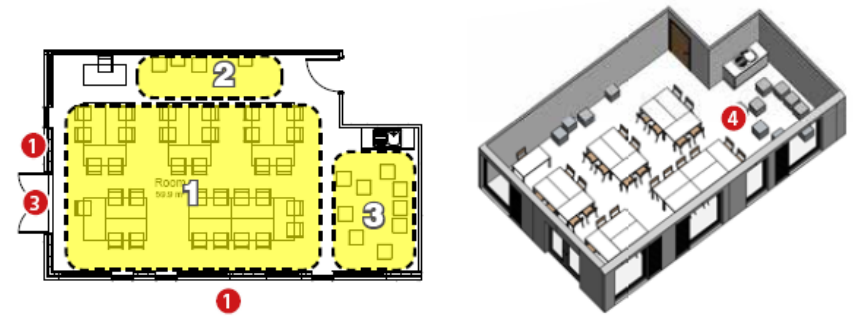

Optimum Schools Classroom

- 1 Maximise daylighting from two sides
- 2 Natural cross ventilation within facade
- 3 Access to outdoor learning
- 4 L-shaped space allows for efficient zoning of uses

